

二重葺用折板部材 一覧表

KBハゼ折板 二重葺断熱工法 部材 30分耐火構造認定断熱金具

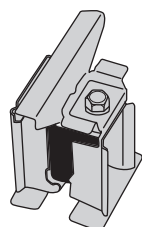

Aタイプ

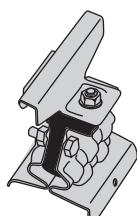

Bタイプ

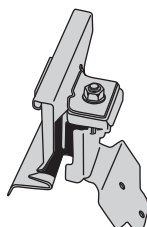

Cタイプ

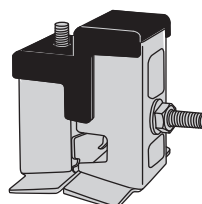

新型Bタイプ

耐火認定 (スライド式)

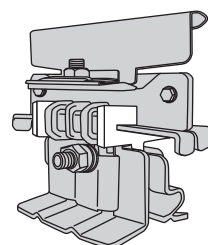

スライド断熱金具

HK 二重葺断熱工法 部材

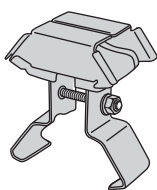

断熱金具

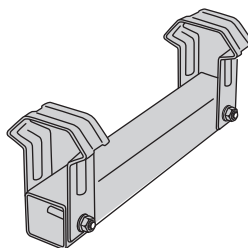

棟用タイトフレームWタイプ (切妻二重用)

KBルーフ折板 二重葺断熱工法 部材

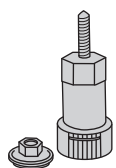

ダンボ88

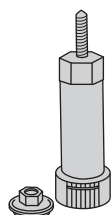

ダンボ100

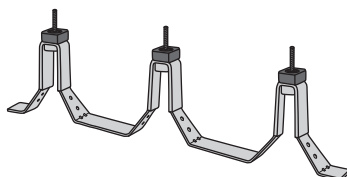

二重葺 断熱金具88

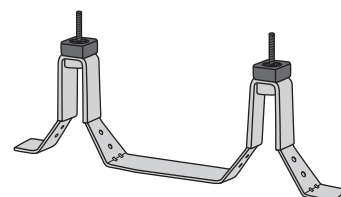

二重葺 断熱金具150

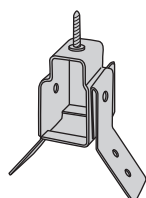

ふき葺88

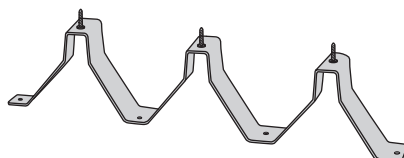

ふき葺II型88

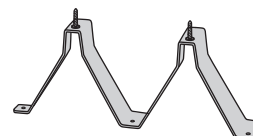

ふき葺II型150

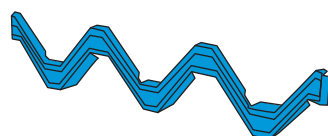

W面戸88

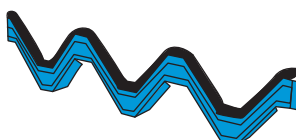

W面戸88 パッキン付

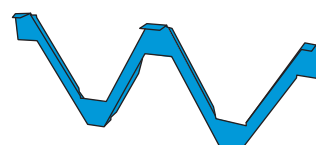

W面戸150